

THESE DRAWINGS AND SPECIFICATIONS ARE THE PROPERTY OF JBL INCORPORATED. THEY ARE ISSUED IN STRICT CONFIDENCE AND SHALL NOT BE REPRODUCED OR USED AS THE BASIS FOR MANUFACTURE OR REPAIRS WITHOUT WRITTEN PERMISSION.

4

3

2

1

REVOLUTIONS		DATE
1/3	DESCRIPTION	3/8/71
A	RELEASE TO MARKETING	3/21/84

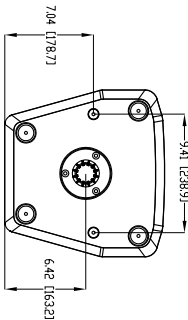
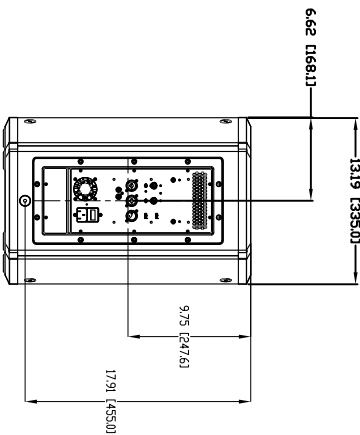
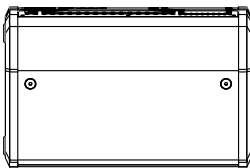
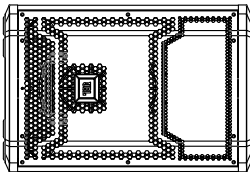
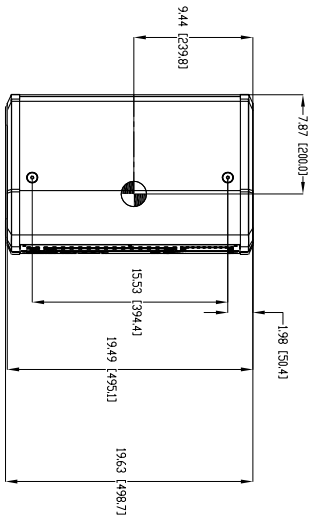
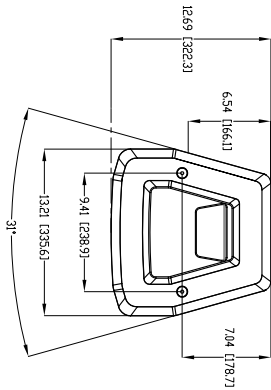

- NOTES UNLESS OTHERWISE SPECIFIED
- COMPONENTS LIST 1X 2616
 - INPUT 2X XLR WITH LOOP THRU
 - GRILLE: 16 GA. PERFORATED CR3 POWDER COATED BLACK WITH CLOTH BACKING
 - MATERIALS: 18mm BIRCH FACED POPLAR
 - FINISH: BLACK DURAFLX
 - SUSPENSION POINTS: 12X M10 THREADED SUSPENSION POINTS
 - POLE MOUNT: DUAL 35mm G-3/8" FEMALE
 - WEIGHT 30 LBS (20 kg)
 - INDICATES CENTER OF GRAVITY

A

B

C

D

4

3

2

1

TOLERANCES UNLESS OTHERWISE SPECIFIED	
XXX	± .063 INCH
XX	± .125 INCH
ANGULAR DIMENSIONS	OF 0°-30°
FRACTIONAL DIMENSIONS	± 1/32
DIMENSIONS ARE IN INCHES	
ALL DIMENSIONS ARE FINISHED DIMENSIONS	
DO NOT SCALE DRAWING	
SCALE	NTS
SHEET	1 OF 1

JBL PROFESSIONAL
A Harman International Company
Northridge, California 91329 U.S.A.

CUSTOMER DRAWING, PRX710

SIZE A DRAWING NO. 1000110920 REV A